

C43 COUPE



WHAT DESIGN INNOVATION LOOKS LIKE.

SPECIFICATIONS

LOA (with swim platform)	42' 0"	12.8 m
Beam	13' 10"	4.21 m
Draft	3' 7"	1.09 m
Weight (dry with standard engines)	24,150 lbs.	10,954 kg
Bridge Clearance (without radar & mast)	10' 10"	3.3 m
Fuel Capacity	342 U.S. gal.	1,295 L
Water System	131 U.S. gal.	495 L
Holding Tank Capacity	70 U.S. gal.	264 L
Cabin Headroom	6' 8"	2.03 m
Sleeps	6	



CARVER
YACHTS

See The Difference.

STANDARD FEATURES

Construction

- Hull and Deck: Hand-laid structural and non-structural fiberglass and core laminates bonded with infused resin.
- Hull bottom: Surface beneath the water line is bead blasted to create an optimal bonding surface for the anti-fouling paint which is sprayed onto the hull to create a smooth running bottom.
- Stringer System: Fiberglass stringers are used throughout the yacht.
- Interior bulkheads, cabinets and drawers are precision cut, hand crafted and constructed from a selection of woods and high-pressure laminates. Drawers are lined with laminate.
- Integral aluminum truss reinforcement in cabin top structure.

Electrical

- 12V System: Powered by an array of Series 31, 12V batteries. Array includes two dedicated engine starting batteries and one dedicated "house" battery. Battery banks are charged by a 60 amp charger for each bank. System voltmeters are located on the ship's 12V distribution panel and voltmeters at the helm station. Battery on/off switch for the house battery is installed in the salon and the selector switch for engine batteries is located in the engine compartment.
- 110V System: System consists of a 30-amp service supported by Marinc® 50' (15.2 m) shore power cord. Ground fault circuit interrupters are incorporated into the onboard system.
- Television: Cable television is supported by onboard inlets in the salon and master stateroom and a 50' (15.2 m) CATV cable to connect to shore outlet.

Propulsion

- Engines: Twin Cummins 6.7 L, 380 HP diesel inboard engines with direct coupled v-drives. Each engine's exhaust is routed to a Hydralift muffler and underwater exhaust port.
- Shafts and Shaft Logs: 1.75" (3.8 cm) diameter stainless steel propeller shafts. Tides Marine® SureSeal shaft logs are self-aligning, dripless and maintenance free. Sacrificial anodes are installed on each shaft.
- Rudders and Propeller Struts: Made from durable 421 Manganese bronze.
- Propellers: Nibral CNC propellers.
- Fuel Tanks: Twin, 5052 aluminum tanks hold 175 gal. (662.4 L) of fuel each. Port and starboard fuel fill deck fittings.
- Trim Tabs: Bennett Marine® stainless steel, electro-hydraulic trim tabs.
- Steering: Teleflex® SeaStar hydraulic steering.
- Helm Display: Digital LCD display showing tachometer, hour meter, oil pressure, coolant temperature, battery voltage, fuel tank level and rudder angle indicator.

Fresh Water & Holding Systems

- Fresh Water System: Three 40 gal. (151.4 L) polyethylene tank with shore water connection and integrated pressure reduction valve.
- Fresh water fill fitting installed on walkway. Eleven gal. (41.6 L) water heater installed in engine compartment.
- On demand fresh water is delivered via a fresh water pump installed in the engine compartment.

Decks & Hardware

- Rails: 1" (2.5 cm) 316 stainless steel rails are used throughout the vessel. Rail stanchion bases are secured using aluminum backing plates laminated into the deck's fiberglass layup.

- Mooring Cleats: 10" (25 cm) mooring cleats are used at the bow, stern and amid ship (total of nine cleats). Cleats are secured using aluminum backing plated fused into the vessel's laminate.
- Foredeck Access: Wide walkways are on each side of the cabin top and provide safe, secure access from the cockpit to the foredeck.
- Foredeck Hatch with screen.

Safety & Navigation

- Bilge Pumps: Two 1,500 gal. (5678 L) per hour automatic bilge pumps are installed, each with a manual on/off switch at the helm. A float switch for the high bilge water alarm is installed in the engine compartment and forward bilge.
- Bilge Ventilation: Four ventilator blowers are installed in the engine compartment. Each blower creates 240 CFM volume.
- CO Alarms: Monitors with alarms are installed in both staterooms and the salon.
- Engine Alarms: Engine oil pressure and water temperature alarms are installed at the helm.
- Fire Suppression System: An FE241 Fireboy® automatic fire suppression system is installed in the C43's engine compartment.
- Compass: 2.75" flush mount, illuminated Richie® Navigator compass is mounted at the helm.
- Seacocks: Marine grade bronze seacocks are used on all below the waterline thru hull openings. Nylon fittings are used on above the waterline outlets.
- Spotlight: ITT Jabsco® remote control spotlight mounted on bow rail.

Helm

- Bench helm seat, adjustable electrical controls.
- Compass.
- Sport steering wheel.
- 12V accessory outlet.
- Provisions for optional navigation equipment including RayMarine E120 display with GPS, chart plotter, depth sounder, radar, VHF and autopilot.
- Windshield defogging fans.
- Dual speed controlled/intermittent windshield wipers and washers.
- 12V switch control panel.
- Remote control spotlight.
- Hydraulic steering with tilt steering wheel.
- Dash console, non-glare.
- Electronic engine controls.
- Trim Tab controls.
- LCD engine information display.
- USB outlet

Cockpit/Transom/Swim Deck

- Swim Platform: Integrated into the yacht's hull and deck. Access to the cockpit from the swim platform is through a transom door on the starboard side of the yacht. Telescoping boarding ladder is installed in recessed area of swim platform.
- Transom: Stainless steel handrail on top of transom. Two storage lockers in aft surface of transom.
- Engine Compartment Access: Hinged cockpit floor hatch with gas shock cylinder.
- Courtesy Lights: Four cockpit courtesy lights with on/off switch.

Standard features (cont.)

- Two storage lockers, port and starboard side.
- Armrest with stainless steel cup holder.
- Storage access under all cockpit seating.
- Shore water connection.
- Dual stereo speakers.
- Overhead LED lights.
- Cockpit Lounge: L-shaped lounge seat to port with single seat on starboard.

Salon

- Entertainment: 32" LED Television, Blu-Ray/CD player, AM/FM marine quality stereo with speakers.
- Lighting: LED lights are recessed into the salon head liner and are controlled by a rocker switch.
- Seating: U-shaped upholstered lounge with storage underneath seating. High/Low dining table with filler cushion.
- Ventilation: Salon windows slide open.
- Storage: Hinged door in salon floor provides access to spacious storage compartment.
- Flooring: Plush pile, 100% nylon carpeting throughout salon.
- CO Detector.
- Retractable sunroof with shade and screen.

Galley



- Counter Tops: Solid surface countertops throughout.
- Flooring: Vinyl plank flooring.
- Appliances: Novacool® refrigerator, convection microwave oven, two burner electric cooktop with ventilator.
- Sink: Full-size stainless steel sink.
- Lighting: Recessed LED lights over galley counter controlled by rocker light switch.
- 110 Outlet: GFI protected 110V outlet.

Master Stateroom

- Sleeping: Queen size, island berth with high-density foam mattress. Dual end tables and halogen scone style reading lights.
- Privacy: Master stateroom is secured with a hinged wooden door and locking door latch.
- Storage: Port and starboard overhead lockers. Port and starboard hanging lockers.

- CO detector.
- Ventilation: Opening overhead hatch with screen and egress ladder.
- Lighting: Natural light provided by overhead hatch and two 5.5" by 36" hull side windows with blinds. Additional illumination provided by 2V lights recessed in the headliner and controlled by a rocker switch and two scone reading lights.
- Flooring: Plush pile 100% nylon carpeting throughout.
- Towel and sheet set.

Guest Stateroom

- Sleeping: Twin berths with high-density foam mattresses. Filler cushion converts twin berths to full size mattress.
- Flooring: Plush pile 100% nylon carpeting throughout.
- Privacy: Guest Stateroom is secured with a hinged wooden door and locking door latch.
- Lighting: Illumination is provided by recessed overhead LED lights controlled by a rocker switch. Two bedside reading lights. Natural light and ventilation provided by one 11" hull side window with opening portlight.
- Hanging locker with illumination and mirror.

Master Head Compartment

- Sleeping: Queen size, island berth with high-density foam mattress. Dual end tables and halogen scone style reading lights.
- Privacy: Master stateroom is secured with a hinged wooden door and locking door latch.
- Storage: Port and starboard overhead lockers. Port and starboard hanging lockers.
- CO detector.
- Ventilation: Opening overhead hatch with screen and egress ladder.
- Lighting: Natural light provided by overhead hatch and two 5.5" by 36" hull side windows with blinds. Additional illumination provided by 2V lights recessed in the headliner and controlled by a rocker switch and two scone reading lights.
- Flooring: Plush pile 100% nylon carpeting throughout.

Day Head

- Shower: Hand held shower with curtain. Sump drain with automatic pump. Exhaust fan. LED overhead light. Molded non-skid floor.
- Toilet: Raritan® electric pedestal toilet with freshwater flush.
- Two 7.5" by 20" hull side windows with opening port lights with shades.
- Vanity: Vanity is equipped with vessel sink, under sink storage, solid surface counter top, mirrored cabinet.
- Lighting: LED lights recessed in the headliner and controlled by wall mounted rocker switch.
- Electrical: 110V GFI protected outlet.

OWNER PREFERENCES

Propulsion

- Twin Cummins QSB 6.7 480 hp Diesel Engines.

Mechanical

- Bow Thruster.
- Bow and Stern Thruster.
- Cummins Joystick.
- Engine Oil Change System.

Electrical

- Westerbeke 10.0 EDT/D-NET Diesel 60 HZ Generator, 120V 240V 83-41 amps.
- Kohler 11.0 KW Diesel - 60 HZ Generator, 120V 240V 91-45.8 amps.
- Westerbeke 7.5 EDT/D-NET Diesel 50 HZ Generator, 230V 32.6 amps.
- Kohler 9.0 KW Diesel - 50 HZ Generator, 230V 39 amps.
- Cablemaster for Shore Power (Only available with high capacity air conditioning option) - 240V/50 amp.
- Air Conditioning, High Capacity - 28,000 BTU Includes single 240V/50 amp shore service).

Water & Waste Systems

- Overboard Discharge.
- Grey Water Holding System.
- Water and Waste Monitor.
- Transom Washdown - Fresh Water Only.
- Transom Washdown - Seawater Only.
- Transom Washdown - Fresh and Seawater.

Safety & Navigation

- A Series Navigation Electronics Package (EE) - Chartplotter, GPS, Sonar, VHF/Hailer.
- A Series Bridge Navigation Electronics and Radar Package (GG) - Radar, 2 x Chartplotter, GPS, Sonar, VHF/Hailer.

- Radar Mast.
- Ground Tackle includes Prince 1000 Windlass, Anchor, Chain, Shackle and Line with Snap Hook.
- Ground Tackle includes Prince 1000 Windlass with Capstan, Anchor, Chain, Shackle and Line with Snap Hook.

Interior

- Satin Wood Finish.
- Wine Cooler for Galley Storage
- Galley Storage - Pull Out Dry Storage.
- Decorator Pillows.
- Salon Blinds.
- Salon Wood Flooring.
- Master Stateroom TV & Blu-Ray Player.
- Second Stateroom TV & Blu-Ray Player.
- Carpet Runner.
- Central Vacuum
- Combination Washer/Dryer

Exterior

- Seat Covers.
- Exterior Teak Table with Cover.
- Exterior Carpet.
- Passerelle - Mounting Reinforcements Only.
- Transom Hand Shower.
- Transom Underwater Lighting.
- Cockpit Icemaker (Not available with Cockpit Refrigerator).
- Cockpit Refrigerator.
- Cockpit Wetbar with Grill.
- Cockpit Sun Shade.
- Salon Door Screen.
- Foredeck Sunpad.
- Colored Hull Upgrade: Sterling Taupe, Carbon Black, Mariana Blue.



Salon

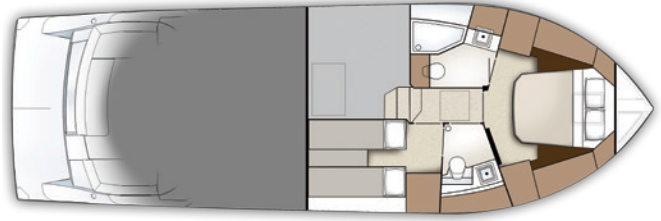

Lower



Information described in this publication is believed to be correct at time of printing. Some accessories shown in photographs, or described, may not be standard equipment or even available as an option. For a full list of standard and optional features, visit www.carveryachts.com. Features are subject to change without notice. Confirm availability of all accessories and equipment with an authorized Carver Yachts dealer prior to purchase.

© Carver Yachts, LLC. Printed in U.S.A. All rights reserved.

CARVER
YACHTS
See The Difference.

790 Markham Drive
Pulaski, WI 54162-1010
carveryachts.com