

52

COMMERCIAL MEDICAL
SUPPORT VESSEL

Specifications

- Length overall: 18.00 metres
- Measured length: 15.80 metres
- Waterline length: 13.40 metres
- Beam amidships: 4.90 metres
- Freeboard at bow: 2.00 metres
- Freeboard at stern: 1.40 metres
- Draft: 1.20 metres
- Displacement (loaded): 23.0 tonnes
- Fuel capacity: 2600 litres
- Water tank capacity: 300 litres
- Engine Make/Model: twin C12 Catapillar 700hp each
- Max Speed (loaded): 28 knots
- Cruising speed: 20 knots
- Chamber: CM1200 Model 3208 twin lock Recompression chamber

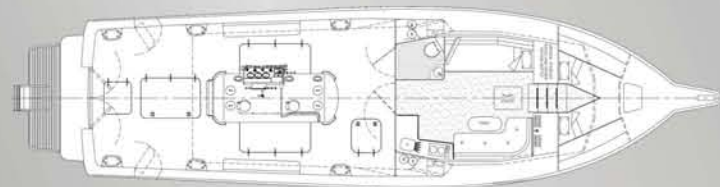

STEBER™



52

COMMERCIAL MEDICAL
SUPPORT VESSEL



STEBER INTERNATIONAL
STEBERCRAFT PTY. LTD.

ABN 99 000 522 163



PO Box 90 Taree NSW 2430
6 Elizabeth Avenue - Taree NSW 2430 Australia
Phone +61 2 6552 2577 Fax +61 2 6551 0344
Email mail@steber.com.au Web www.steber.com.au

S52-03-10

WWW.STEBER.COM.AU



Australian Made



STEBER

