

**STEBER™**



*Seamphony*

**FISH'N'FUN 0402 211 454**

M6

Commercial / Utility / Recreation

28





## 28 Commercial / Utility / Recreation Specifications

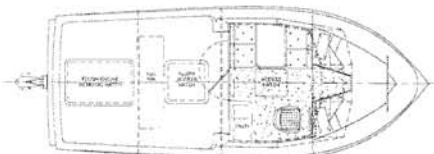
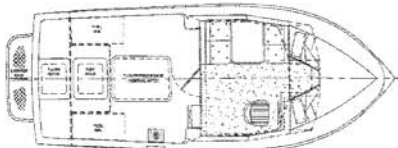
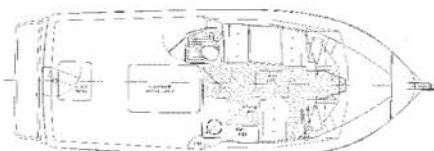

**Moulded length:** 8.30m (28')  
**Water-line length:** 7.30m (24')  
**Beam at transom:** 2.98m (9'9")  
**Beam amidships:** 3.3m (10'10")  
**Water-line beam:** 2.70m (8'10")  
**Displacement:\*** approx 4.2 tonne  
**Fuel capacity:** 500 litres  
**Recommended H.P.:** single 150hp to 300hp  
 twin 130hp to 150hp  
**Sleeping capacity:** 2 persons  
**Cockpit floor area:** 10 sq m (approx)

\* weights vary according to chosen engines & options



**STEER INTERNATIONAL**  
 STEERCRAFT PTY. LTD.  
 ABN 99 000 522 163



PO Box 90 Taree NSW 2430  
 6 Elizabeth Avenue - Taree NSW 2430 Australia  
 Phone +61 2 6552 2577 Fax +61 2 6551 0344  
 Email mail@steber.com.au Web www.steber.com.au